



Setting the pace
Castors for hospital and care beds



Setting the pace

Castors for hospital and care beds



TENTE is synonymous for innovative and high-quality designs in every aspect of castor development. High quality standards during the development refined production techniques during the manufacturing stage, made us the market leader. Every TENTE castor is certified according to DIN/ISO 9001 manufactured and tested according to EN 12526 - EN 12533 standards.

One of TENTE's specialty areas are castors for the hospital and care market. This area has particularly high demands.

Deciding factors:

- durability
- stability
- washability
- easy manoeuvrability
- Raw material used in the production of these castors, are resistant to most cleaning agents and disinfectants.
- Sealed precision ball bearings allow regular cleaning without problems

Like any other TENTE castor made for the medical industry, these won't leave markings – no matter what floor they roll on.

Various locking and brake options play an important part in this area.

Available versions:

- total lock: lock swivel and wheel simultaneously
- central lock: One action to lock or unlock multiple castor. The lever remains in the same place.

Central locking castors have three positions:

- total locking
- neutral
- directional locking.

TENTE offers compatibility and interchangeability for the health care industry. The use of different fittings allows for an easy exchange of current castors with TENTE castors.

TENTE covers every aspect and fulfills your wishes!

The following pages show currently available TENTE hospital bed and care bed castors.



LINEA Hospital Bed Castor

Series 5940

Unique

To increase the level of comfort and safety for patients, hospital beds should be as low as possible.

Therefore, TENTE developed the LINEA series of twin wheel castors, with an overall height merely a few millimeters larger than the wheel diameter.

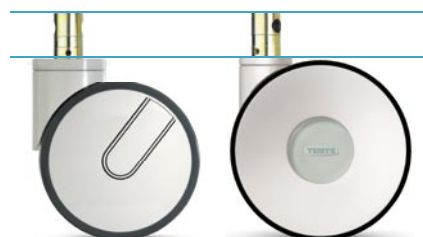

Comparison of the overall height
125 mm Wheel-Ø 150 mm Wheel-Ø

Thus, a 150 mm castor has an overall height of only 155 mm. This provides smooth rolling properties of a 150 mm castor with fitting dimensions of a conventional 125 mm twin wheel castor.



Awards for excellent Design



Award for Good Design
International Forum Design



High product quality
Interzum Award



Gute Gestaltung
German Designer Club



The Design Award of the
Federal Republic of Germany
NOMINATED

Advantageous

- Two precision ball bearings in the swivel head provide for a particularly easy swivel action
- The maintenance-free central locking engages with the toothed interior of the wheel rim
- Smooth surfaces reduce the accumulation of dirt and allow for easy clean up
- The colour of the castor can be ordered to match bed frames and connecting parts
- A transparent, non-rotating cover in the wheel's centre offers space for a company logo, or a different coloured insert to advertise important properties, such as, electric conductive or washability
- Elegant design creates confidence and trust with the patients

Housing:

Made of high grade synthetic materials.
Two precision ball bearings in the swivel head.

Wheels:

UAP Wheel centre: Polyamide
Tread: Polyurethane,
precision ball bearing

UAC Wheel centre: Polyamide
Tread: Polyurethane,
precision ball bearing
stainless, washable

USC Electric conductive,
non-marking
Wheel centre: Polyamide
Tread: Polyurethane
precision ball bearing,
stainless, washable

Available as:

5940 Swivel castor

5944 Swivel castor with total- or
directional lock

5946 Swivel castor with total lock

Wheelsizes: 125 mm and 150 mm Ø
Load capacity: 150 kg per castor



Electrical conductive
versions can be recognised
by the yellow swivel bearing
cover.

Fittings:



R36-34 XS



R36-32



R05

Colours:



RAL 9002
grey-white



RAL 7001
silver-grey

Twin wheel castor

Series 2940

Specific

- Castors in the health care market have to fulfill the highest demands
- Durability, stability, washability and easy manoeuvrability are basic criteria
- TENTE twin wheel castors provide low roll and swivel resistance, which in turn offer a smooth and comfortable ride

Robust

- The castor's framework is made of two steel pressed halves to withstand the high stress caused by shocks
- The individual parts do not deform or break
- The polyurethane treaded synthetic wheels are made of high grade and reinforced base material
- Increased rolling comfort coupled with specially low rolling and swivelling resistances

Housing:

Frame made of pressed steel, precision ball bearing in swivel head and wheel, housing cover made of synthetic plastics

Wheels:

- UAP Wheel centre: Polyamide
Tread: Polyurethane, precision ball bearing, washable version with sealed precision ball bearing available
- XSX electric conductive, non-marking
Wheel centre: Polyamide
Tread: Polyamide
Tread: Polyurethane precision ball bearing, sealed, washable

Available as:

- 2940 Swivel castor
2944 Swivel castor with total- or directional lock
2946 Swivel castor with total lock

Wheelsizes:

100 mm, 125 mm and 150 mm Ø
Load capacity depends per castor:
125 kg up to 150 kg per castor



Electrical conductive versions can be recognised by the yellow dot.

Fittings:



R26-28



R36-34

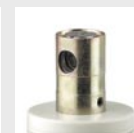

R36-32



R05



Awards for excellent Design



Award for Highest Design Quality presented by the Design-Center North Rhine Westphalia



Gute Gestaltung German Designer Club



The Design Award of the Federal Republic of Germany
NOMINATED

Certified



INTEGRAL

Series 2040 / Series 7040



Solid

- A robust brake system and a solid steel housing are especially capable of resisting stress caused by shock load
- Outstanding manoeuvrability, and minimal force required, when pushing a bed, are ensured by the ideal combination of precision ball bearings, polyurethane tread and the wheel's excellent geometry
- The easy to operate actuation system performs particularly quiet
- Beautifully designed synthetic semi cover are snapped on and ultrasonically welded. They function as a bumper, absorbing lateral impacts elastically and without permanent deformation
- TENTE INTEGRAL: A symbol for stability, long endurance and safety

Series 2040

Housing:

Frame made of pressed steel, blue zinc plated, precision ball bearing in swivel head and wheel, housing cover made of synthetic plastics

Wheels:

- UAP Wheel centre: Polyamide
Tread: Polyurethane, precision ball bearing
- UAX Wheel centre: Polyamide
Tread: Polyurethane, precision ball bearing, sealed
- XSX electric conductive, non-marking
Wheel centre: Polyamide
Tread: Polyurethane, precision ball bearing, sealed, washable

Wheelsizes:
125 mm, 150 mm and 200 mm Ø
Load capacity: 150 kg per castor



Awards for excellent Design



Award for Highest Design Quality presented by the Design-Center North Rhine Westphalia



Award for Good Design International Forum Design

Certified



Series 7040



Housing:

Frame made of stainless steel, precision ball bearing in swivel head and wheel, housing cover made of synthetic plastics

Wheels:

- UAX Wheel centre: Polyamide
Tread: Polyurethane, precision ball bearing, sealed
- XSX electric conductive, non-marking
Wheel centre: Polyamide
Tread: Polyurethane, precision ball bearing, sealed, washable

Wheelsize: 150 mm Ø
Load capacity: 150 kg each

Available as:

- 2040/7040 Swivel castor
- 2044/7044 Swivel castor with total- or directional lock
- 2046/7046 Swivel castor with total lock

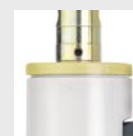

Electrical conductive versions can be recognised by the yellow swivel bearing cover.

Fittings:



R26-28

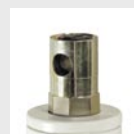

R36-34



R36-32



R05

Colours:



RAL 9002
grey-white



RAL 9006
white-aluminium

DECORA

Series 5440

Demanding

- Perfectly suited for the modern design specifications set forth in the medical market for hospital and care applications
- Fulfils the current hygienic standards to a high degree
- TENTE DECORA satisfies the highest demands made on design, functionality and technical perfection

Elegant

- An elegant, self supporting housing made of high grade synthetic material
- Reliable TENTE PJP wheels offer smooth and quiet operation
- The locking mechanism is integrated in the stem fitting
- The locking system has been constructed by utilizing new materials which reduce noise and optimize the actuation force
- Identical construction height and fitting dimensions allow to easily exchange current castors with the DECORA

Housing:

Made of high grade synthetic materials, with integrated threadguards, precision ball bearing in swivel head and wheel, housing cover made of synthetic material

Wheels:

PJP Wheel centre: Polypropylene
Tread: TENTEprene (thermoplastic rubber) with integrated threadguards, precision ball bearing

Available as:

- 5440: Swivel castor
- 5444: Swivel castor with total- or directional lock
- 5446: Swivel castor with total lock

Wheelsizes: 100 mm and 125 mm Ø

Load capacity: 100 kg per castor

Fittings:



R26-28

R36-32

R05



Awards for excellent Design

 Award for Highest Design Quality presented by the Design-Center North Rhine Westphalia

 The Design Award of the Federal Republic of Germany NOMINATED

Colours:



RAL 9002
grey-white

RAL 7001
silver-grey

COVER DESIGN

Series 2070/Series 2470

Proven

- Based on the well-known 2470 series, which has been proven a million times over
- The solid metal construction of the 2470 series has been transformed into an elegant bed castor by means of snap on design covers

High-quality

- Integrated mechanics for total and directional locking functions
- Modern manufacturing combined with TENTE's high-quality standards

Advantageous

- Solid construction
- High dynamic load capacity
- Good roll and swivel resistances

Series 2070

Housing:

Made of pressed steel, zinc-chromatised, with additional snap-on synthetic cover, double ball bearing swivel head, axle riveted

Wheels:

- PJP Wheel centre: Polypropylene
Tread: TENTEprene (thermoplastic rubber) with threadguards, precision ball bearing
- XSX electric conductive, non-marking
Wheel centre: Polyamide
Tread: Polyurethane, with threadguards
precision ball bearing, sealed

Wheelsizes: 125 mm and 150 mm Ø

Load capacity: 100 kg each

Colours:



RAL 9002
grey-white



RAL 9006
white-aluminium



Series 2470

Housing:

Housing made of pressed steel, zinc-chromatised, double ball bearing swivel head, wheel axle with nut

Wheels:

- PJO Wheel centre: Polypropylene
Tread: TENTEprene (thermoplastic rubber) without threadguards, plain bearing
- YGO electric conductive, non-marking
Wheel centre: Polypropylene
Tread: TENTEprene (thermoplastic rubber) without threadguards
plain bearing
- PJP Wheel centre: Polypropylene
Tread: TENTEprene (thermoplastic rubber) with threadguards, precision ball bearing
- XSX electric conductive, non-marking
Wheel centre: Polyamide
Tread: Polyurethane, with threadguards
precision ball bearing, sealed

Wheelsizes:

100 mm, 125 mm und 150 mm Ø

Load capacity: 100 kg per castor,
PJO 100 mm Ø = 80 kg per castor

Available as:

- 2070/2470 Swivel castor
- 2074/2474 Swivel castor with total- or directional lock
- 2076/2476 Swivel castor with total lock

Fittings:



R26-28

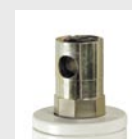

R36-34

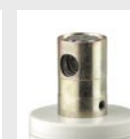

R36-32



R05

Fittings

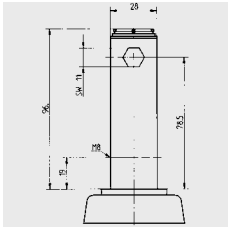

Fitting R26-28 S 45 M8 Standard

Tube fitting for 28 mm inside tube diameter.
 M8 threaded hole for fitting with two screws in the direction to travel, 19 mm from the top of the castor to the centre of the fitting hole.
 Cam hole 90 degrees to the direction of travel.

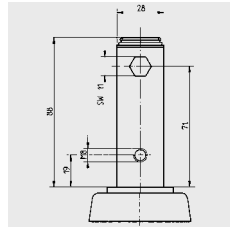

Fitting R36-28 S 45 M8 Sonderausführung

Tube fitting for 28 mm inside tube diameter.
 M8 threaded hole for fitting with two screws 90 degrees to the direction of travel, 19 mm from the top of the castor to the centre of the fitting hole.
 Cam hole 90 degrees to the direction of travel.

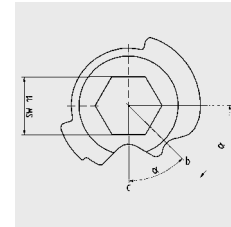

Cam positions:

- a) Total lock
- b) Neutral
- c) Directional lock

Actuating options α

- 2 x 45° or
- 2 x 30°

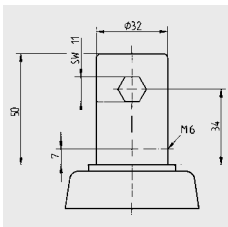

Fitting R36-32 S 30 M6 Standard

Tube fitting for 32 mm inside tube diameter.
 M6 threaded hole for fitting with two screws in the direction to travel, 7 mm from the top of the castor to the centre of the fitting hole.
 Cam hole 90 degrees to the direction of travel.

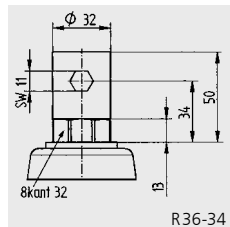

R36-34

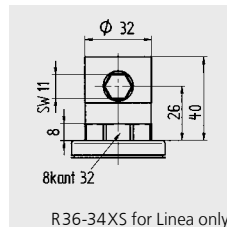

R36-34XS for Linea only

Fittings R36-34 und R36-34XS

Tube fitting for 32 mm inside tube diameter.

Advantages:

- The stem will be vertically fixed by the hexagonal bar
- Torsion will be avoided by the octagonal profil bar
- Adjustment with the frame of the bed
- Fitting screws are not necessary