

LEVINA

5387XSC100R05-18x62

EAN 4031582359695

Swivel castor with total lock, tail end of castor, housing made from high grade synthetic materials with metal parts made of Stainless Steel, double ball bearing swivel head, solid plug fitting. Wheel centre made of Polyamide, electric conductive, tread made of Polyurethane, with threadguards, precision ball bearing, stainless

Hint: These castors are also with grey locking lever available.



BETTER MOBILITY. BETTER LIFE.



Picture may differ from original product

Technical Data

Wheel diameter	100 mm
Wheel width	32 mm
Bolt-Ø	18 mm
Bolt length	62 mm
Offset	36 mm
Swivel Interference	196 mm
Overall height	137 mm
Temperature	- 10 / + 40 °C
Standard	EN_12530
Swivel Radius	98 mm
Hardness of tread	Shore A 91
Load capacity	100 kg
Load capacity (static)	200 kg

Advantages at a glance

Roll performance	● ● ● ○ ○
Movement noise	● ● ● ● ○
Attrition	● ● ● ● ○
Corrosion resistance	● ● ● ● ●

Dimensions

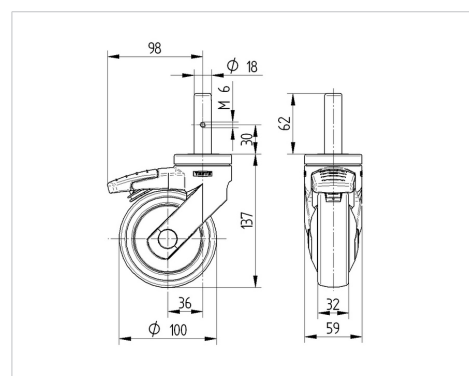

Structure & Mounting

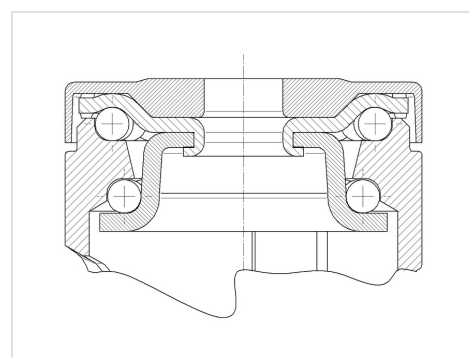

PRODUCT INFORMATION

LEVINA

5387XSC100R05-18x62

EAN 4031582359695



BETTER MOBILITY. BETTER LIFE.

Structure & Mounting

