

8476PID200P67

EAN 4031582381771

Swivel castor with central total lock, Housing made of Stainless Steel, double ball bearing swivel head, wheel axle with nut, plate fitting with integrated central lock. Wheel centre made of Polypropylene, Tread: solid rubber, grey non-marking, roller bearing made of stainless steel



BETTER MOBILITY. BETTER LIFE.



Picture may differ from original product

Technical Data

Wheel diameter	200 mm
Wheel width	46 mm
Size of Plate	176 x 112 mm
Plate hole centres	105 x 77.5 mm
Plate hole	13 mm
Offset	55 mm
Swivel Interference	310 mm
Overall height	240 mm
Temperature	- 20 / + 80 °C
Standard	EN_12532
Weight	3.279 kg
Swivel Radius	155 mm
Hardness of tread	Shore A 74
Load capacity	205 kg
Load capacity (static)	410 kg

Dimensions

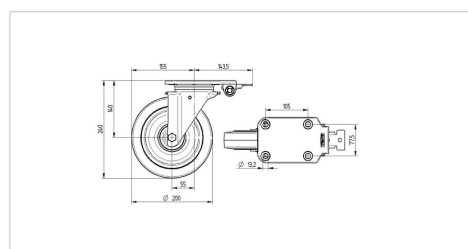

Structure & Mounting

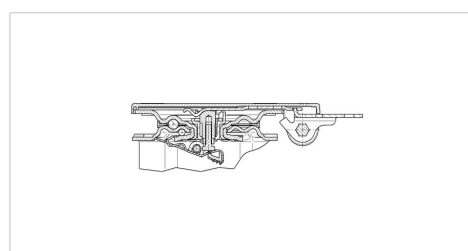

Advantages at a glance

Roll performance	● ● ● ○ ○
Movement noise	● ● ● ● ●
Attrition	● ● ● ○ ○
Corrosion resistance	● ● ● ○ ○

8476PID200P67

EAN 4031582381771



BETTER MOBILITY. BETTER LIFE.

Structure & Mounting

