

**LINEA****5941UAP125P30-11 RAL9002**

EAN 4031582369229

Swivel castor with directional lock, housing made of Polyamide, precision ball bearing in swivel head, bolt hole. Wheel centre made of Polyamide, Tread: Polyurethane, precision ball bearing

**TENTE**

BETTER MOBILITY. BETTER LIFE.



Picture may differ from original product

**Technical Data**

Wheel diameter	125 mm
Wheel width	20 mm
Castor width	82 mm
Centre hole	11 mm
Dome-Ø	52 mm
Offset	40 mm
Swivel Interference	258 mm
Overall height	143 mm
Temperature	- 10 / + 40 °C
Standard	EN_12530
Weight	0.955 kg
Swivel Radius	129 mm
Hardness of tread	Shore A 92
Load capacity	130 kg
Load capacity (static)	260 kg

**Advantages at a glance**

Roll performance	● ● ● ● ●
Movement noise	● ● ● ○ ○
Attrition	● ● ● ● ○
Corrosion resistance	● ● ● ● ○

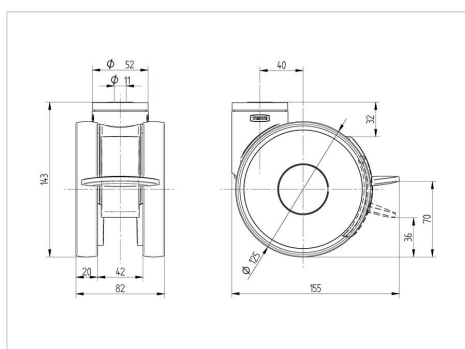
**Dimensions****Structure & Mounting**