

8476UFX160P67

EAN 4031582380545

Swivel castor with central total lock, Housing made of Stainless Steel, double ball bearing swivel head, wheel axle with nut, plate fitting with integrated central lock. Wheel centre made of Polyamide, Tread: elastic-tyre, non-marking, with small threadguards, precision ball bearing, sealed



BETTER MOBILITY. BETTER LIFE.



Picture may differ from original product

Technical Data

Wheel diameter	160 mm
Wheel width	46 mm
Castor width	99 mm
Size of Plate	176 x 112 mm
Plate hole centres	105 x 77,5 mm
Plate hole	13 mm
Dome-Ø	96 mm
Offset	55 mm
Swivel Interference	287 mm
Overall height	200 mm
Temperature	- 20 / + 80 °C
Standard	EN_12532
Weight	1.877 kg
Swivel Radius	143.5 mm
Hardness of tread	Shore A 63
Load capacity	250 kg
Load capacity (static)	500 kg

Advantages at a glance

Roll performance	● ● ● ○ ○
Movement noise	● ● ● ● ●
Attrition	● ● ● ○ ○
Corrosion resistance	● ● ● ● ●

Dimensions

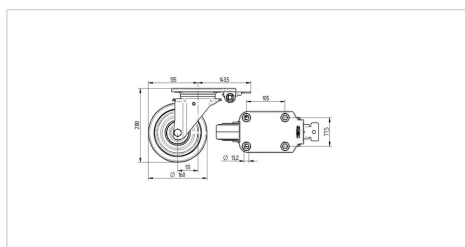

Structure & Mounting

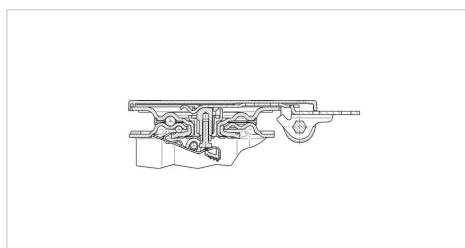

8476UFX160P67

EAN 4031582380545



BETTER MOBILITY. BETTER LIFE.

Structure & Mounting

