



BETTER MOBILITY. BETTER LIFE.

Foot Protection Ø125

EAN 4031582439021

Flexible foot protection for maximum occupational safety; suitable for use with our 3640, 4680, 9650 and 9680 housing ranges, as fixed, swivel or locking castor models.



Picture may differ from original product

Technical Data

Temperature	- 4 / + 140 °F
Weight	1.190 lbs
Suitable wheel sizes	4.92 in
Length	7.28 in
Width	5.94 in
Ground clearance	0.79 in
Hardness of rubber flap	A 75 Shore

Dimensions

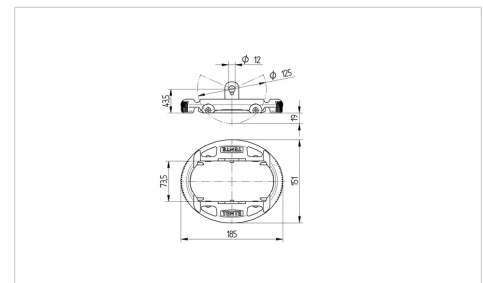

Advantages at a glance

Roll performance	○ ○ ○ ○ ○
Movement noise	○ ○ ○ ○ ○
Attrition	● ● ● ○ ○
Corrosion resistance	● ● ● ○ ○