

AGILA

2477UAP100P30-11

EAN 4031582302219

Swivel caster with total lock, trailing end of caster, housing made of pressed steel, bright zinc plated, blue passivated, double ball bearing swivel head, wheel axle with nut, bolt hole. Wheel center made of Polyamide, Tread: Polyurethane, precision ball bearing, with threadguards casters can be mounted with standard screws; various length screws can be used.



BETTER MOBILITY. BETTER LIFE.



Picture may differ from original product

Technical Data

Wheel diameter	3.94 in
Wheel width	1.26 in
Caster width	2.36 in
Center hole	0.43 in
Dome-Ø	2.36 in
Offset	1.71 in
Swivel Interference	10.31 in
Overall height	5.31 in
Temperature	- 13 / - 13 °F
Standard	EN 12530
Weight	1.757 lbs
Swivel Radius	5.16 in
Hardness of tread	Shore D 42
Load capacity (dynamic)	220 lbs
Load capacity (static)	440 lbs

Advantages at a glance

Roll performance	● ● ● ○ ○
Movement noise	● ● ● ○ ○
Attrition	● ● ● ● ○
Corrosion resistance	● ● ● ○ ○

Dimensions

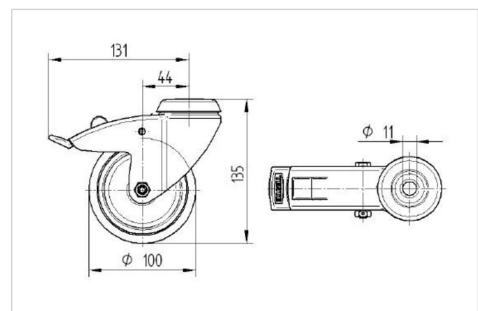

Structure & Mounting

