

INTEGRAL TWIN

2946UAP100R26-28S45 4xM8

EAN 4031582302585

Swivel caster with central lock, Frame made of pressed steel, precision ball bearing in swivel head, housing with synthetic cover, stem with cam hole for profile bars. Wheel center made of Polyamide, Tread: Polyurethane, precision ball bearing
Hint: TÜV Süd certified product.



BETTER MOBILITY. BETTER LIFE.



Picture may differ from original product

Technical Data

| | |
|-------------------------|-----------------|
| Wheel diameter | 3.94 in |
| Wheel width | 0.59 in |
| Caster width | 2.48 in |
| Bolt-Ø | 1.10 in |
| Bolt length | 3.78 in |
| Dome-Ø | 2.42 in |
| Offset | 1.22 in |
| Swivel Interference | 6.69 in |
| Overall height | 5.08 in |
| Temperature | - 13 / + 176 °F |
| Standard | EN 12531 |
| Weight | 2.306 lbs |
| Swivel Radius | 3.35 in |
| Hardness of tread | Shore D 42 |
| Load capacity (dynamic) | 275 lbs |
| Load capacity (static) | 825 lbs |

Advantages at a glance

| | |
|----------------------|-----------|
| Roll performance | ● ● ● ● ● |
| Movement noise | ● ● ● ○ ○ |
| Attrition | ● ● ● ● ○ |
| Corrosion resistance | ● ● ● ○ ○ |

Dimensions

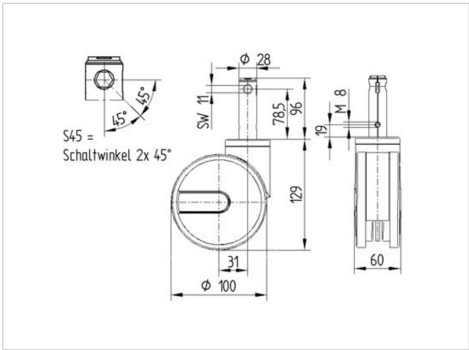

INTEGRAL TWIN

2946UAP100R26-28S45 4xM8

EAN 4031582302585



BETTER MOBILITY. BETTER LIFE.

Structure & Mounting



Design Award Winner

German Designer Club



**reddot design award
winner**

