

# KAPPA

## 9682FTP200P63 WT60

EAN 4031582315806

Swivel caster with total lock, leading end of caster, housing and plate steel-welded, bright zinc plated, blue passivated, sealed single swivel double ball bearing, threaded king pin and locking nut secured, grease nipple, wheel axle with nut, plate fitting. Wheel center made of cast iron, Tread: Polyurethane, casted, precision ball bearing



BETTER MOBILITY. BETTER LIFE.



Picture may differ from original product

### Technical Data

Wheel diameter	7.87 in
Wheel width	2.36 in
Caster width	4.57 in
Plate size	5.31 x 4.33 in
Plate hole centers	4.13 x 3.15/2.95 in
Plate hole	0.43 in
Dome-Ø	4.37 in
Offset	2.32 in
Swivel Interference	12.60 in
Overall height	9.65 in
Temperature	+ 14 / + 140 °F
Standard	EN 12533
Weight	19.645 lbs
Swivel Radius	6.30 in
Hardness of tread	Shore A 92
Load capacity (dynamic)	2205 lbs
Load capacity (static)	4410 lbs

### Advantages at a glance

Roll performance	● ● ● ● ○
Movement noise	● ● ● ○ ○
Attrition	● ● ● ● ○
Corrosion resistance	● ● ● ○ ○

### Dimensions

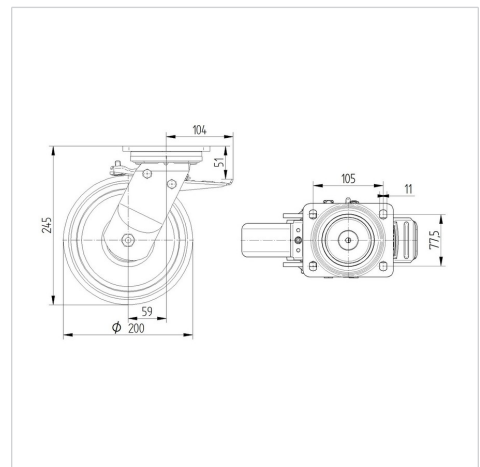

### Structure & Mounting

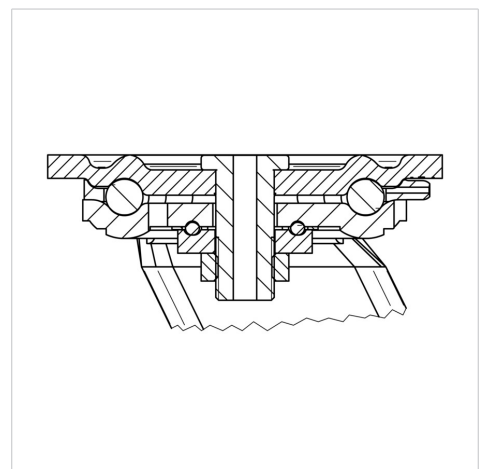

# KAPPA

9682FTP200P63 WT60

EAN 4031582315806



BETTER MOBILITY. BETTER LIFE.

## Structure & Mounting

