

LEVINA

5381PJC125P30-13

EAN 4031582358988

Swivel caster with directional lock, housing made from high grade synthetic materials with metal parts made of Stainless Steel, double ball bearing swivel head, bolt hole. Wheel center made of Polypropylene, Tread: TENTEprene (thermoplastic rubber), grey non-marking, with threadguards, precision ball bearing, stainless



BETTER MOBILITY. BETTER LIFE.



Picture may differ from original product

Technical Data

Wheel diameter	4.92 in
Wheel width	1.26 in
Caster width	2.32 in
Center hole	0.51 in
Dome-Ø	2.32 in
Offset	1.50 in
Swivel Interference	7.91 in
Overall height	6.34 in
Temperature	- 14 / + 104 °F
Standard	EN 12530
Weight	1.261 lbs
Swivel Radius	3.96 in
Hardness of tread	Shore A 87
Load capacity (dynamic)	220 lbs
Load capacity (static)	440 lbs

Dimensions

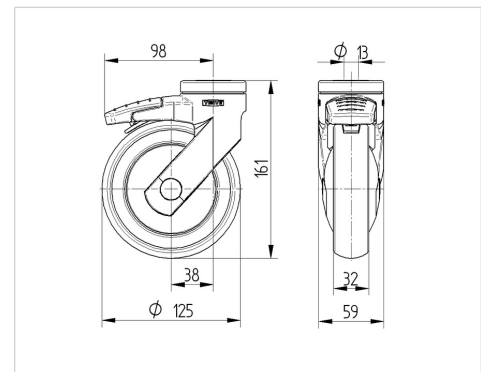

Structure & Mounting

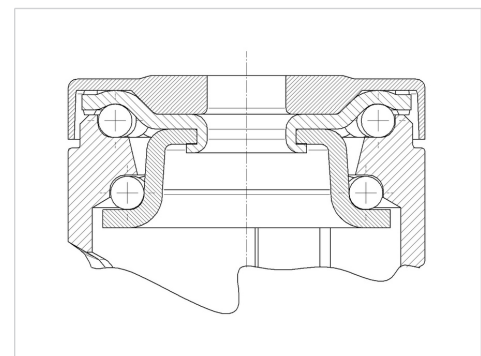

Advantages at a glance

Roll performance	● ● ● ○ ○
Movement noise	● ● ● ● ○
Attrition	● ● ● ○ ○
Corrosion resistance	● ● ● ● ●

LEVINA

5381PJC125P30-13

EAN 4031582358988



BETTER MOBILITY. BETTER LIFE.

Structure & Mounting

