

LEVINA

5381XSC125P52

EAN 4031582426236

Swivel caster with directional lock, housing made from high grade synthetic materials with metal parts made of Stainless Steel, double ball bearing swivel head, plate fitting. Wheel center made of Polyamide, electric conductive, tread made of Polyurethane, with threadguards, precision ball bearing, stainless



BETTER MOBILITY. BETTER LIFE.



Picture may differ from original product

Technical Data

Wheel diameter	4.92 in
Wheel width	1.26 in
Plate size	3.74 x 2.76 in
Plate hole centers	2.05/1.75 x 2.99/2.83 in
Plate hole	0.43 in
Offset	1.50 in
Swivel Interference	7.91 in
Overall height	6.50 in
Temperature	- 14 / + 104 °F
Standard	EN 12530
Swivel Radius	3.96 in
Hardness of tread	Shore A 91
Load capacity (dynamic)	220 lbs
Load capacity (static)	355 lbs

Structure & Mounting

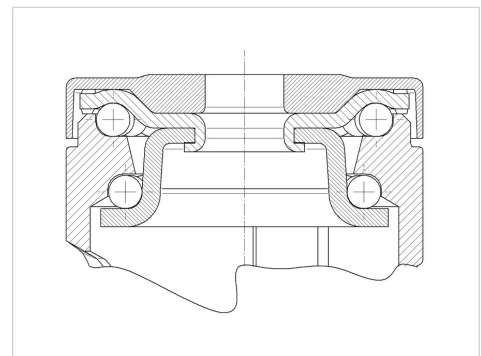

Advantages at a glance

Roll performance	● ● ● ○ ○
Movement noise	● ● ● ○ ○
Attrition	● ● ● ● ○
Corrosion resistance	● ● ● ● ●

LEVINA

5381XSC125P52

EAN 4031582426236



BETTER MOBILITY. BETTER LIFE.

Structure & Mounting

